



MURPHY®

by **ENOVATION** CONTROLS

LARGE, FULL-COLOR DISPLAY BRINGS POWER TO RUGGED APPLICATIONS

POWERSVIEW®
1200



Largest display in the PowerView line at 12.3-in.

Boasts high-speed processor and wide format display

Easy-to-use configuration software

CAN-based display with rich, full-color graphics

Bonded glare-free LCD screen



Enovation Controls brings a new experience to rugged applications with the PowerView 1200. Offering more memory and more real estate, PV1200 shows vital engine and application information on one ultra-wide screen. With 8 GB of storage, the PV1200 is powered by a 1.5 GHz processor to provide ample room for configuration and drive seamless graphics.

The 12.3-inch screen can be easily viewed, even in full sunlight. The display's bonded LCD and rugged design make it a perfect solution for all types of environments and applications. Available with non-touch and touch (glove-touch) variants/options, the PV1200 is tailored for your application.

Customization of the display can be accomplished quickly via graphical programming or scripting with the PowerVision Configuration Studio® software. This tool allows for quick creation of personalized user interfaces, custom parameters and specialized graphics for on-screen text, OEM branding and more.

POWerview® 1200

DIMENSIONS

Front

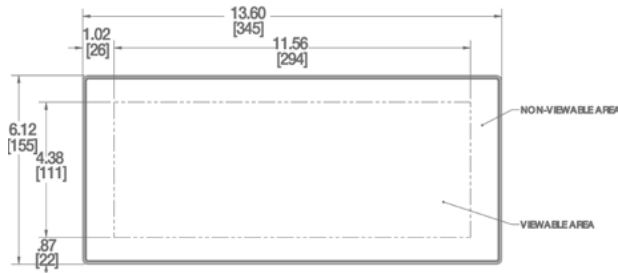

Side

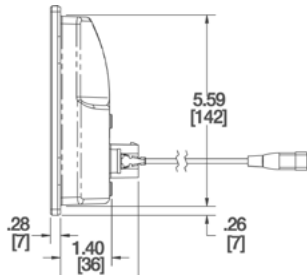

Back

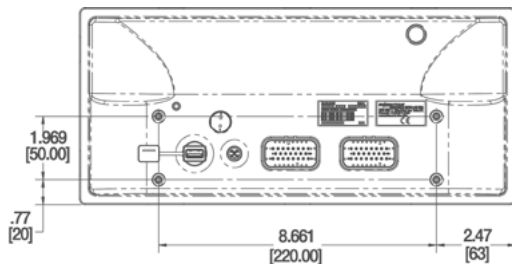

SPECIFICATIONS

COMPUTING:

- Main Processor: Renesas R-Car M2, 32 Bit Arm Cortex A15 Processor @ 1.5 GHz
- Operating System: QNX® Realtime Operating System
- Storage: 8 GB Flash memory
- RAM: 512 MB DDR3-SDRAM
- Graphics: PowerVR SGX544MP2 (3D) (Option)
- Renesas graphics processor (2D)

HARDWARE:

- Display Type: 12.3" (320 mm (H) x 130 mm (V)) LVDS IPS LCD with LED backlight
- Color: 24-Bit color
- Resolution: 1280 x 480
- Contrast Ratio: Typ. 800:1
- Brightness: 1000 cd/m²
- Surface: Anti-glare, touch panel
- Real Time Clock: with battery backup
- Connectors: (2) Ampseal 23 pin (Main)
(1) M12, 5-pin (optional)
(1) USB pigtail
- Video input: (3) NTSC/PAL

COMMUNICATION:

- CAN: (2) CAN 2.0B according to ISO-11898-2; J1939 and proprietary messaging
- Serial: (1) RS-485 serial (Modbus: Master/Slave)
- USB: (2) USB 2.0 Full Speed Host

ELECTRICAL:

- Operating Voltage: 6 – 36 VDC, Reverse polarity protected
- Outputs: (1) 500 mA Switched Low-side
(1) Frequency Output (2Hz – 3KHz)
- Inputs: (3) Analog 0–5 VDC, 4-20 mA, Resistive, 10-bit resolution
(5) Discrete digital, active-high
(1) Frequency In (2Hz - 10kHz) 5Vpk-pk min, 49V pk-pk max

ENVIRONMENTAL:

- Operating Temperature: -20°C to +70°C [-4°F to +158°F]
- Storage Temperature: -40°C to +85°C [-40°F to +185°F]
- Protection: IP66 and IP67, front and back, for outdoor use
- Vibration: 7.86 Grms (5 – 2000Hz), 3 axes
- Shock: ±50G in 3 axes
- EMC/EMI: SAEJ1113, ISO13766, CE per 2014/30/EU

ENOVATION CONTROLS CORPORATE HEADQUARTERS
5311 S 122ND EAST AVENUE
TULSA, OK 74146

ENOVATION CONTROLS LTD. – UNITED KINGDOM
CHURCH ROAD LAVERSTOCK
SALISBURY SP1 1QZ UK

SUN MURPHY INTERNATIONAL TRADING (SHANGHAI) CO., LTD
B15 ROOM, 6# BUILDING, 351 SIZHUAN ROAD
SONGJIANG DISTRICT, SHANGHAI 201601, CHINA

ENOVATION CONTROLS INDIA PVT. LTD.
301, 3RD FLOOR, KRISNA CHAMBERS,
11 GALAXY GARDENS, NORTH MAIN ROAD,
KOREGAON PARK, PUNE 411001,
MAHARASHTRA, INDIA

U.S. SALES & SUPPORT

PHONE: 918 317 4100
EMAIL: SALES@ENOVATIONCONTROLS.COM
WWW.ENOVATIONCONTROLS.COM

MURPHY INDUSTRIAL PANEL DIVISION

PHONE: 918 317 4100
EMAIL: IPDSALES@ENOVATIONCONTROLS.COM

INTERNATIONAL SALES & SUPPORT

EUROPE, MIDDLE EAST, AFRICA
PHONE: +44 1722 410055
EMAIL: SALES@ENOVATIONCONTROLS.EU

CHINA
PHONE: +86 21 6237 5885
EMAIL: APSALES@ENOVATIONCONTROLS.COM

INDIA
PHONE: +91 91581 37633
EMAIL: INDIA SALES@ENOVATIONCONTROLS.COM

